

musikteatret

Holstebro

Technical specs for Teater Salen

Capacity:	1187 seated + 4 wheelchairs
Stage:	Height: 100 cm, according to first row. Depth: Behind proscenium: 22 mtr. When orchestra pit used as stage: 24 mtr. Width: Proscenium: 15 mtr. Behind proscenium: 20 mtr. clearance: ??????
Front Curtain:	automated and speed controlled front curtain in Bourdoux velvet.
Flybars & Rigging:	42 pcs. Motorised Trekwerk flybars - Max load 500 kg. Spaced in the stage area. <i>See flybar plan for details.</i> 2 pcs. CM Loadstar 320 kg. Chain hoists in proscenium with 12 mtr. 30x30 truss. 6 mtr. 40x40 truss - controlable from flybar system. Roof accessible for more rigging points. <i>See flybar plan for details.</i>
Houselight:	Houselight controllable from FOH & Stage.
Drapes:	8 pcs. Borders, black velvet - Height: 3-4 mtr. 20 pcs. Legs, black velvet - 2 - 4 mtr. Height 10 mtr. 1 pcs. backdrop, black velvet, 18 x 10 mtr. 1 pcs. Carberet styled backdrop, black velvet, 18 x 10 mtr. 1 pcs. Black bobbinnet, 18 x 10 mtr. 1 pcs. White PVC Screen, 18 x 10 mtr.
Power Outlets:	4 pcs. 3 x 16A 3fase+N+J. 1 pcs. 3 x 32A 3fase+N+J. 3 pcs 3 x 63A 3fase+N+J. 3 pcs 3 x 125 3fase+N+J. <i>See placements on drawing.</i>
Load in:	1 pcs. 5 x 6 mtr. Gate at ground level. 1 pcs. ramp available. Access to forklift if needed.

Main PA: 3 pcs. L'acoustics ARCS 1st. gen (LR).
9 pcs. L'acoustics dV-dosc (C).
4 pcs. L'acoustic SB 218 flown center.
2 pcs. L'acoustic MTD 108 - flown downfill over proscenium.
4 pcs. L'acoustic XT5 - frontfills on stage edge lowered so not visible for audience.
All main speakes are powered by L'acoustic LA8 amps.

5 pcs. L'acoustic MTD 108 - flown delay for the 2nd balcony.
Delay speakers is powered by L'acoustic LA4X amp.

Input/routing: Analog Left/Right.
acesable from FOH & Stage.

Tielines FOH - Stage: 1 pcs. Pinason 48/16 analog multicore for sound / DS
6 x DMX
4 x Cat6e
2 x BNC

Followspot: 2 pcs. LYCIAN Stagelightning 1200 Watt, longthrow lens
Placed on balcony. Intercom available for communication.

Camera & LEDTV: Camera placed in FOH. Output can be shown on LEDTV placed in Stage left, right, backstage and Crew area.

Node stands & lights: 30 pcs. node stands, with cabled lamps.

Podiums: 30 pcs. 1x2m podiums on various size of legs.

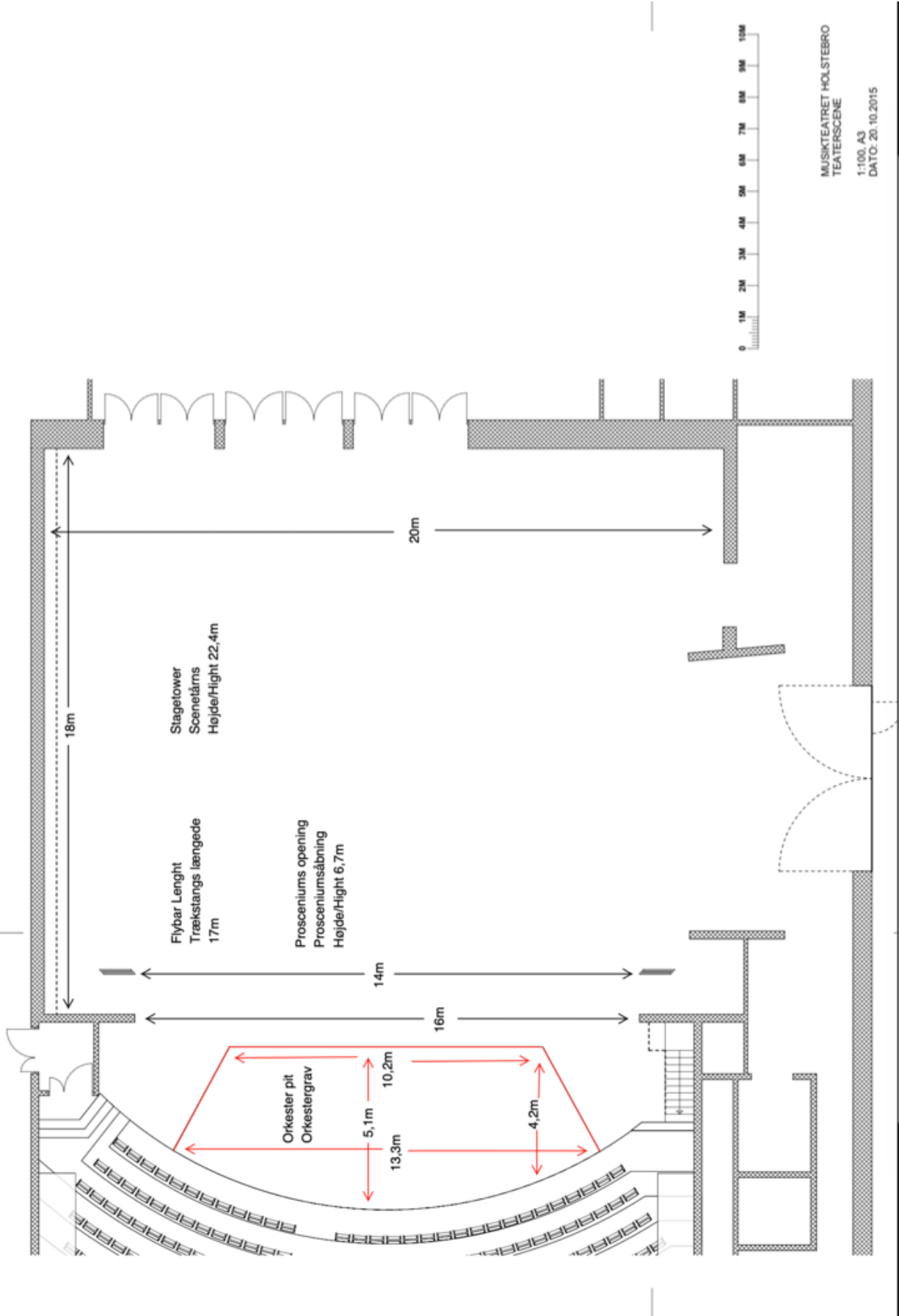

MUSIKTEATRET HOLSTEBRO
 TEATERSCENE
 1:100, A3
 DATO: 20.10.2015

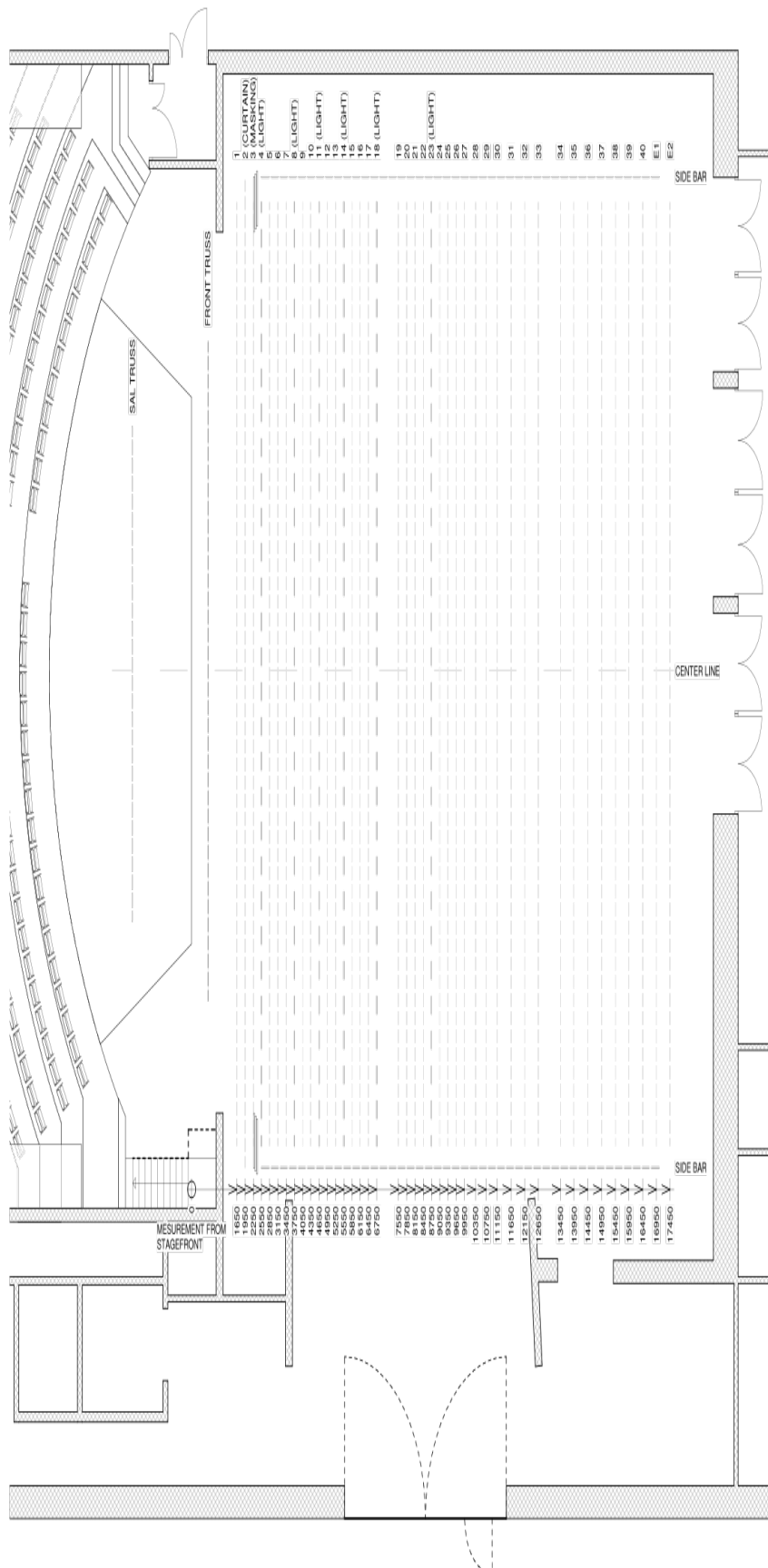

WEIGHT LIMITS:
 GENERAL: 500 KG
 SIDE: 400 KG
 LIGHT: 440 KG
 TOTAL LIMIT: 10.000 KG



MUSIKTEATRET HOLSTEBRO
 TRÆKPLAN
 TEATERSCENE

1:100, A3
 DATO: 29.12.2016

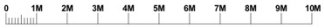
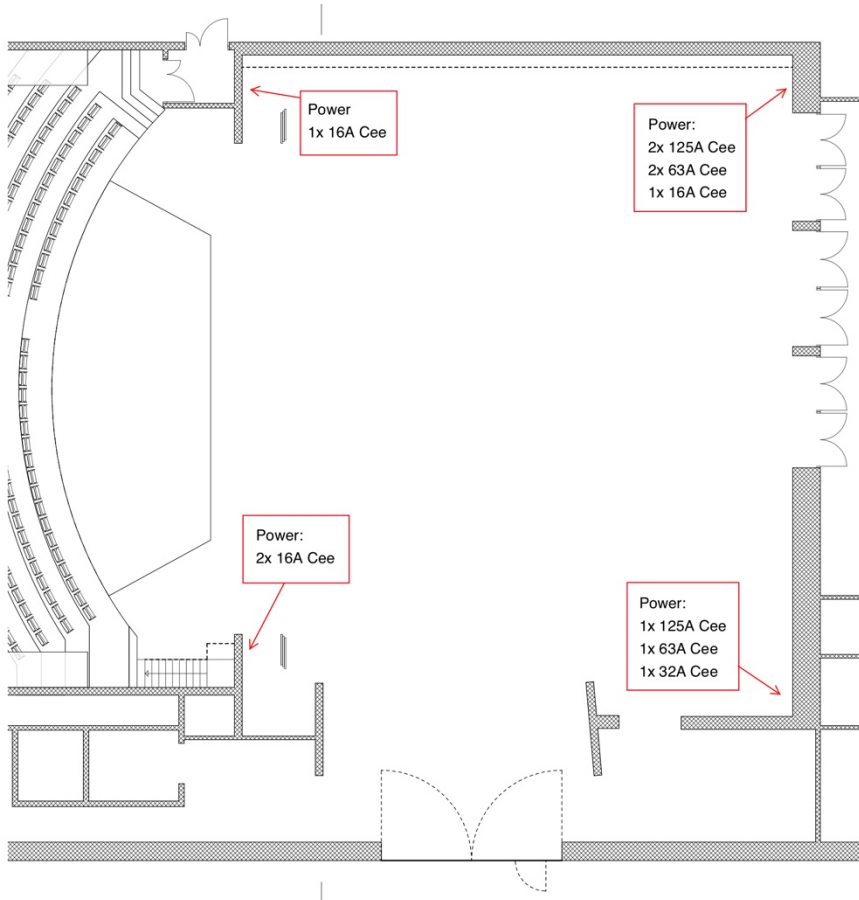

MUSIKTEATRET HOLSTEBRO
 TEATERSCENE
 1:100, A3
 DATO: 20.10.2015